

This tutorial will quickly explain how to take the AIM Capture App **offline**.

If your WiFi connection is weak, AIM recommends that you work offline and upload your images when the signal becomes stronger.

This will prevent your data connection bouncing between 3G and WiFi.





1. Login under your individual username.



2. Click the yellow button that says - **Offline Taking Mode**.

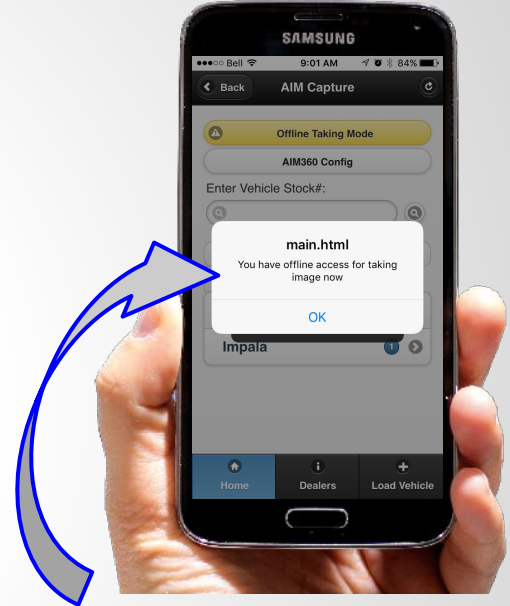

3. The AIM Capture App will automatically download your inventory list allowing you to work Offline.

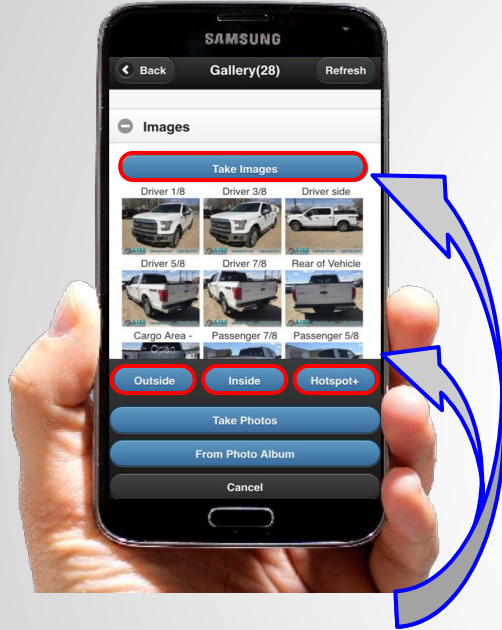

4. Click **Take Images** like you normally would.

- Click **Outside**, **Inside** or **Hotspot** to automatically create an AIM360 virtual tour.

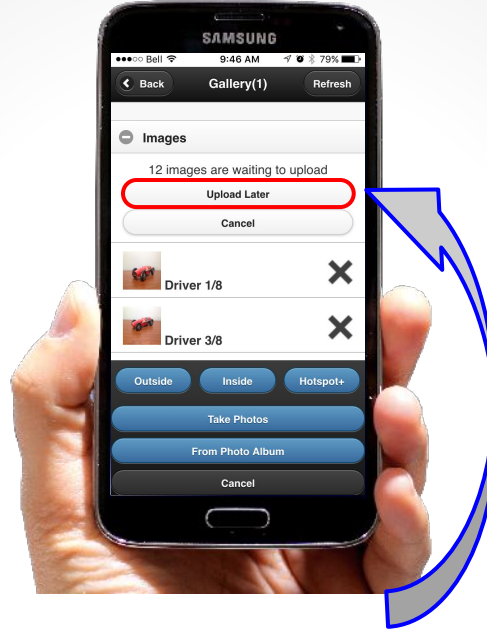

5. After taking the images, click **Upload Later** or continue taking more images.

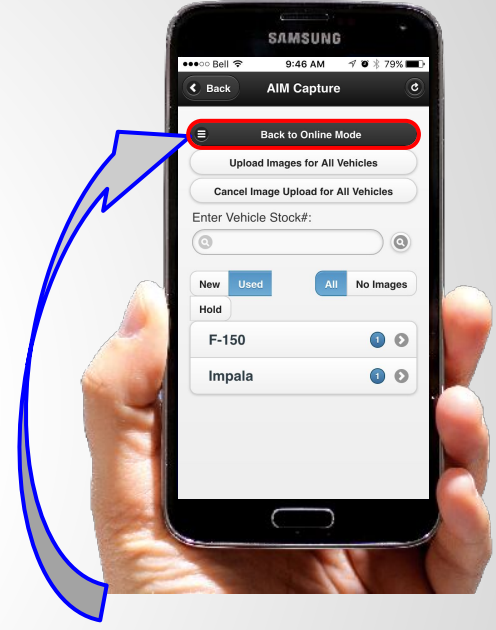

6. Once you are finished, go back **Online Mode** on the main page and the Capture App will begin uploading your images.

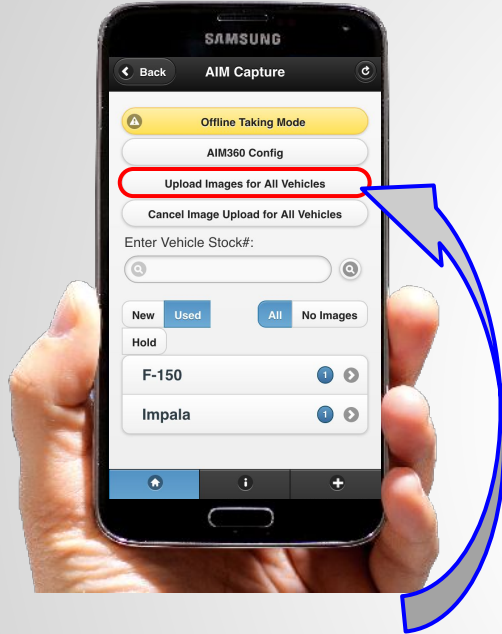

7. Once you're back Online, click Upload Images for All Vehicles.

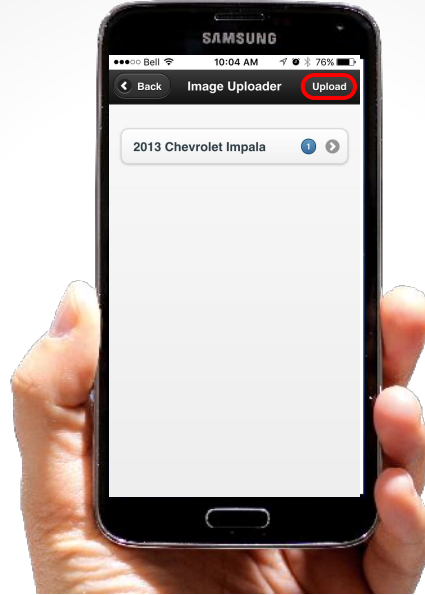

8. The inventory list is waiting and ready to Upload.

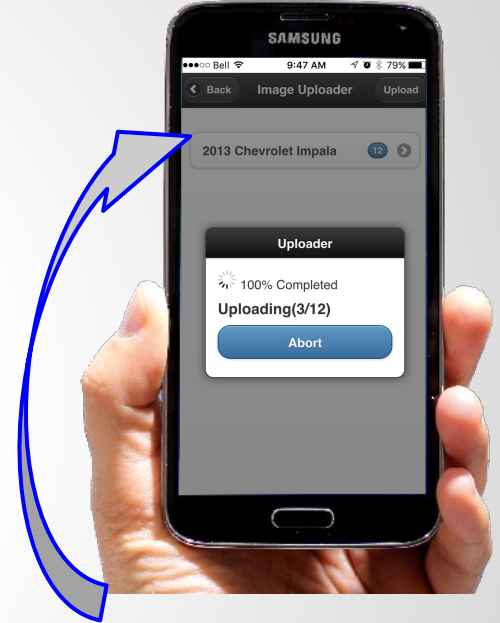

9. Finished!!